

- Wide resistance range
- Thick film, non-inductive design
- Widely used in switch power and AC, DC pulse circuit

RMG10(TO220 TO247)
RMG10 TO220 TO247 Power type, plastic sealed resistor

Applicable specifications

- GB/T5729-2003
- Q/RU339-2004 RMG10

Technical and standard electrical specifications

- Rated Power: TO220 (10W 20W 35W 50W)
TO247 (100W)
- (TCR $10^{-6}/^{\circ}\text{C}$): ± 150 ($R \geq 1\Omega$); ± 600 ($R < 1\Omega$)
- Maximum Working Voltage: 300V
- Maximum pulse Voltage: 670V
- (50Hz 10mA Max): Withstand Voltage: 1800V_{AC} (500V)
- Insulation Resistance: $R_1 \geq 10G\Omega$
- Max torque for mounting: 0.9 mN.m

Derating

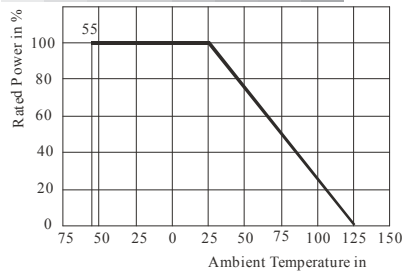

Dimensions

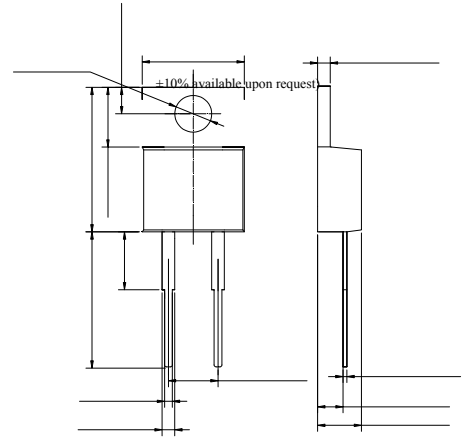

TO220

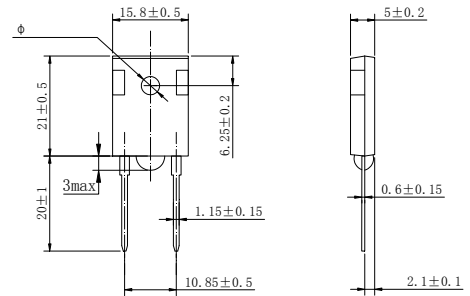

TO247

Performance

Test	Conditions of test	Test Limits
Transient Over-load	2P _R ,5s	R \leq ±(1%R 0.01Ω)
Thermal Shock	-55°C~ 125°C,5 cycles	
Damp heat, steady state	40°C,RH 90~95 %,48h	
Terminal Strength	10N,10s	
Vibration(High frequency)	10Hz~500Hz,250m/s ² ,1.5h	
Endurance at room temperature	25°C ,U _R , 1000h	R \leq ±(5%R 0.1Ω)

Ordering Information

RMG10 – 35W – 15Ω – J

Type – Power(w) – Nominal Resistance – Tolerance

Specifications are subject to change without notice.